

## 3 x 6,5" + 15" 3-Way Line-Array Front-System

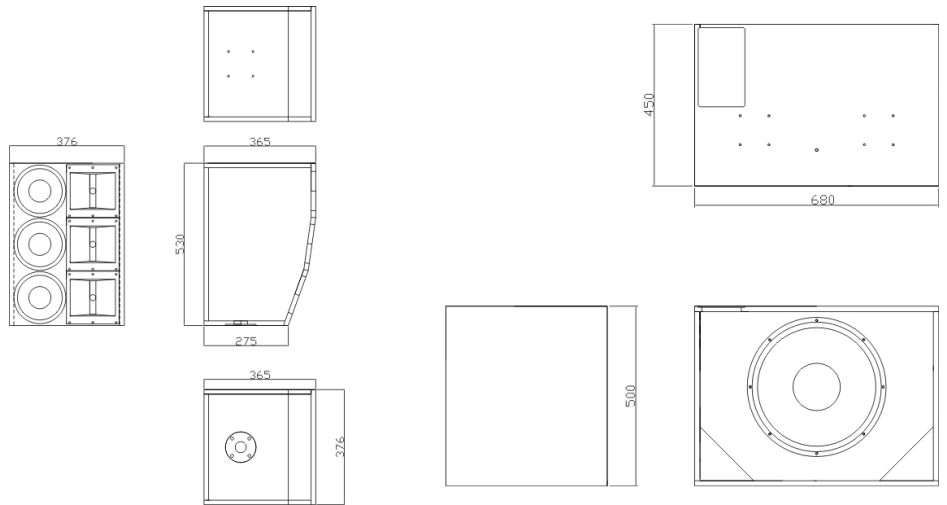

### NCS L33C Line Array

- ▶ 360 W / 720 W power handling
- ▶ 90° x 36° dispersion
- ▶ Vertical array design
- ▶ High SPL

### NCS 115QB Subwoofer

- ▶ 600 W / 1.200 W power handling
- ▶ Very low power compression
- ▶ Integrated voice coil cooling system
- ▶ Vented cabinet design
- ▶ Deep and clear bass reproduction

### NCS L33C Line Array

The NCS L33 F/C is a two-way high performance screen channel loudspeaker system. The cabinet is equipped with three 1" HF drivers (1.75" voice coil), which are mounted onto an vertical array horn design. The NCL L33 F/C is available in two versions with different vertical angles. The nominal coverage of the F version is 90° x 15° (H x V). The C version has a coverage of 90° x 36° (H x V). The MF/LF frequency range is covered by three 120 Watts 6,5" speaker which are mounted in a non vented cabinet to ensure very clear and low / mid reproduction. The system can be driven in passive mode. Therefore a passive crossover is installed. The cabinet is constructed by 15mm wood, covered with Black NOVA PolyCoat© finish and equipped with several M6 and M8 screws and a 35mm speaker stand adapter which ensures the safe and stable connection to the optional accessories. Four open end sockets are mounted on the back of the cabinet for signal input and link output. The power rating of the NCS L33 C line array cabinet is 360 W at 3.2 Ohms.

### NCS 115QB Subwoofer

The NCS 115 QB is a high performance screen channel bass system. The LF frequency range is covered by an 600 Watts 15" speakers which are mounted in a perfect tuned vented cabinet design to ensure clear and deep bass reproduction. The system can be driven in active mode. The recommended crossover frequency is between 70 and 120 Hz. The cabinet is constructed by 15mm wood, covered with Black NOVA PolyCoat© finish and equipped with several M6 and M8 screws which ensures the safe and stable connection to the optional accessories. Four open end sockets are mounted on the top of the cabinet for signal input and signal link output. The power rating of the NCS 115 QB subwoofer is 600 W at 8 Ohms.

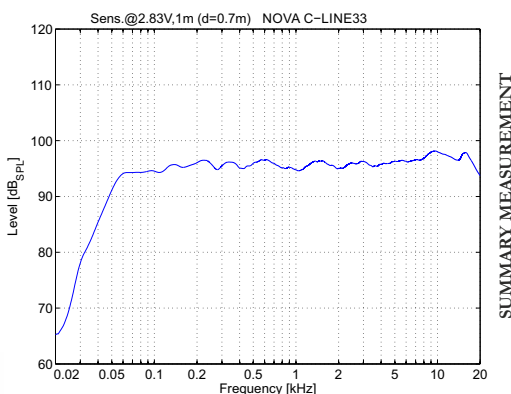

All measurements have been generated with FOUR AUDIO - WINMF / ROBO3 frontend. All measurements under free field conditions.



## 3 x 6,5" + 15" 3-Way Line-Array Front-System

### NCS L33C Line Array

|  |  |
|--|--|
| Article number:                                | # 00616 (C-LINE 33 system) including subwoofer                       |
| System Type:                                   | 3 x 6" configuration   |
| Frequency Range:                               | 80 Hz - 20 kHz   |
| Coverage Pattern:                              | 90° x 36° nominal  |
| Crossover Modes:                               | Passive  |
| Crossover Frequency:                           | 1.25 kHz   |
| Power Rating<br>(Continuous / Program / Peak): | Passive: 360 W / 720 W / 1.440 W<br>Active LF: n/a<br>Active HF: n/a |
| System Sensitivity (1w/1m):                    | 103 dB SPL   |
| LF Driver:                                     | 3 x NOVA 6/100C  |
| LF Nominal Impedance:                          | 3.2 ohms   |
| HF Driver:                                     | 3 x NOVA C1000, 1.75 in. voice coil compression driver               |
| HF Nominal Impedance:                          | 3.2 ohms   |
| Active Tunings:                                | n/a  |
| Enclosure:                                     | NOVA ProWo© MDF, 16 mm   |
| Suspension / Mounting:                         | n/a  |
| Finish:  | Black NOVA PolyCoat© finish  |
| Grille:  | n/a  |
| Dimensions (W x H x D):                        | 376 mm x 530 mm x 365 mm   |
| Net Weight:                                    | 25 kg (each)   |
| Optional Accessories:                          | # 00507: NCS-S Stacking Adapter                                      |

IEC filtered noise with 6 dB crest factor. / Calculated based on power rating and sensitivity.  
CRAAFT AUDIO GmbH continually engages in research related to product improvement. Materials, design and sound tuning are introduced on existing products. Any current product of CRAAFT AUDIO GmbH may differ in some respect from its published description. CRAAFT AUDIO GmbH will always equal or exceed to original design unless otherwise noted. Limited liability on contents. Subjects to change without prior notice.

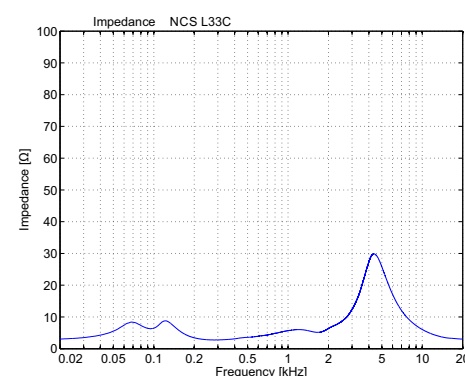
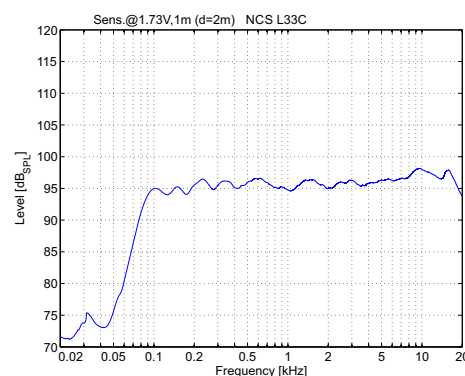

### NCS 115QB Subwoofer

|  |  |
|--|--|
| Article number:                                | # 00616 (C-LINE 33 system) including line array cabinet(s)             |
| System Type:                                   | 15" configuration  |
| Frequency Range:                               | 44 Hz - 1.2 kHz  |
| Coverage Pattern:                              | n/a  |
| Crossover Modes:                               | Passive  |
| Crossover Frequency:                           | 70 - 120 Hz (recommended)  |
| Power Rating<br>(Continuous / Program / Peak): | Passive: 600 W / 1.200 W / 2.400 W<br>Active LF: n/a<br>Active HF: n/a |
| System Sensitivity (1w/1m):                    | 100 dB SPL   |
| LF Driver:                                     | 1 x NOVA 15/600C   |
| LF Nominal Impedance:                          | 8 ohms   |
| HF Driver:                                     | n/a  |
| HF Nominal Impedance:                          | n/a  |
| Active Tunings:                                | 70 - 120 Hz (recommended)  |
| Enclosure:                                     | NOVA ProWo© MDF, 16 mm   |
| Suspension / Mounting:                         | n/a  |
| Finish:  | Black NOVA PolyCoat© finish  |
| Grille:  | n/a  |
| Dimensions (W x H x D):                        | 680 mm x 500 mm x 450 mm   |
| Net Weight:                                    | 30 kg (each)   |
| Optional Accessories:                          | # 00507: NCS-S Stacking Adapter  |

IEC filtered noise with 6 dB crest factor. / Calculated based on power rating and sensitivity.  
CRAAFT AUDIO GmbH continually engages in research related to product improvement. Materials, design and sound tuning are introduced on existing products. Any current product of CRAAFT AUDIO GmbH may differ in some respect from its published description. CRAAFT AUDIO GmbH will always equal or exceed to original design unless otherwise noted. Limited liability on contents. Subjects to change without prior notice.

